

# ERIN & EASY

## DESIGNED TO IMPRESS

CRIOCARBIN  
TASTE PRESENTATION





Modularity and transparency find their best expression in Erin and Easy: the display counters specifically designed for promotional and impulse sales areas.

Every detail, from see-through surfaces to the colour impact achieved through the “Total White” or “Total Black” look, has been designed to guide the eye of the customer to the product on display. Highly flexible in its construction, it can fit any point of sale layout catering for each and every need.

**IT**

Modularità e trasparenza si esprimono al massimo in Erin e Easy, i banchi perfetti per le aree promozionali e le vendite d'impulso.

Tutto, nel loro design, è studiato per attirare l'attenzione del cliente verso il prodotto esposto: dalla trasparenza delle superfici fino al particolare impatto cromatico “Total White” o “Total Black”. La grande flessibilità nella realizzazione consente di adattare il layout del punto vendita a tutte le esigenze.

# ERIN

Erin attracts the consumer's attention thanks to the maximum transparency of all surfaces, perfectly highlighting the food on display and promoting 360° accessibility.

Thanks to its condensers, which are equipped with a self-cleaning system, ordinary maintenance operations can be reduced by 80%.

## IT

Erin attira l'attenzione del consumatore grazie alla massima trasparenza delle sue superfici, mettendo perfettamente in evidenza il cibo esposto e favorendo un'accessibilità a 360°.

Grazie ai suoi condensatori dotati di sistema autopulente consente di ridurre dell'80% gli interventi di manutenzione ordinaria.

## FR

Erin attire l'attention du consommateur, grâce à la grande transparence de toutes les surfaces, en mettant parfaitement en évidence la nourriture exposée et en favorisant une accessibilité à 360 degrés.

Grâce à ses condensateurs munis d'un système auto-nettoyant, il permet de réduire de 80% les travaux de maintenance courante.

## DE

Erin zieht die Aufmerksamkeit des Verbrauchers dank der maximalen Transparenz seiner Oberflächen auf sich, wodurch die ausgestellten Lebensmittel perfekt zur Geltung kommen und ein Zugang von allen Seiten gefördert wird.

Dank der selbstreinigenden Kondensatoren reduziert sich die routinemäßige Wartung um 80 %.

- 1 Height-adjustable glass shelves.  
**IT** Ripiani in vetro regolabili in altezza  
**FR** Étagères en verre réglables en hauteur.  
**DE** Höhenverstellbare Glasböden.

- 2 4000° K LED lighting. (opt)  
**IT** Illuminazione LED 4000° K. (opt)  
**FR** Éclairage LED 4000° K. (opt)  
**DE** LED-Beleuchtung 4000° K. (opt)

- 3 Silkscreen-printing colours.  
**IT** Colori serigrafie.  
**FR** Couleurs sérigraphiées.  
**DE** Siebdruckfarben.

R290 natural refrigerant



■ P73 - Black □ D90 - White

# ERIN XL

Erin XL is a refrigerated island that stands out for its exceptional load capacity. Its maximum visibility and transparency make it the ideal display for the food retail and large-scale distribution sectors.

**IT**  
Erin XL è un' isola refrigerata che si distingue per la sua eccezionale capacità di carico. La massima visibilità e trasparenza lo rendono l'espositore ideale per il settore del food retail e della GDO.

**FR**  
Erin XL est une île réfrigérée qui se distingue par sa capacité de charge exceptionnelle. Sa visibilité et sa transparence maximales en font le présentoir idéal pour le secteur de la vente au détail alimentaire et de la grande distribution.

**DE**  
Erin XL ist eine Kühlinsel, die sich durch ihre außergewöhnliche Tragfähigkeit auszeichnet. Seine maximale Sichtbarkeit und Transparenz machen es zum idealen Display für den Lebensmitteleinzelhandel und den Großhandel.

**1** Screen printing colors.  
**IT** Schienale in Plexiglas trasparente.  
**FR** Couleurs de sérigraphie.  
**DE** Siebdruckfarben.

**2** 4000° K LED lighting. (opt)  
**IT** Illuminazione LED 4000° K. (opt)  
**FR** Éclairage LED 4000° K. (opt)  
**DE** LED-Beleuchtung 4000° K. (opt)

**3** Height-adjustable glass shelves.  
**IT** Ripiani in vetro regolabili in altezza.  
**FR** Étagères en verre réglables en hauteur.  
**DE** Höhenverstellbare Glasböden.

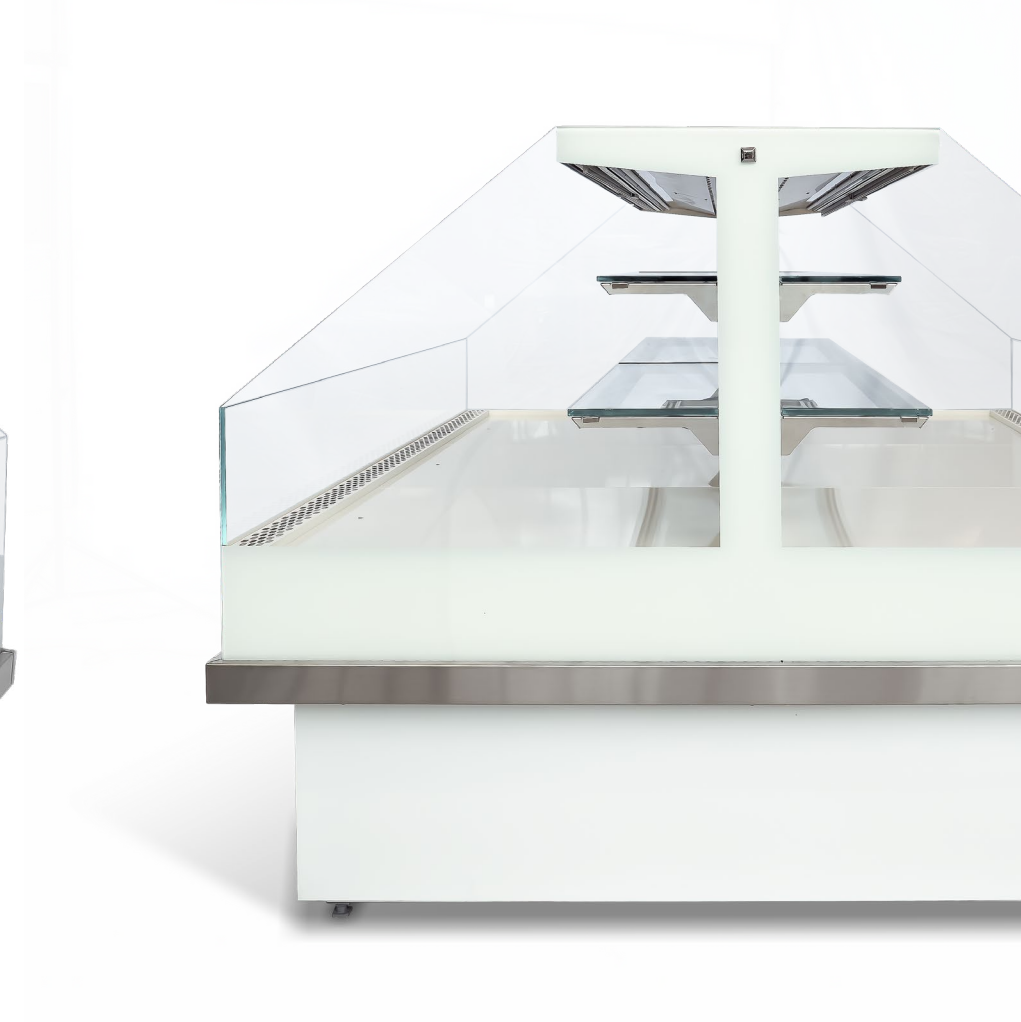
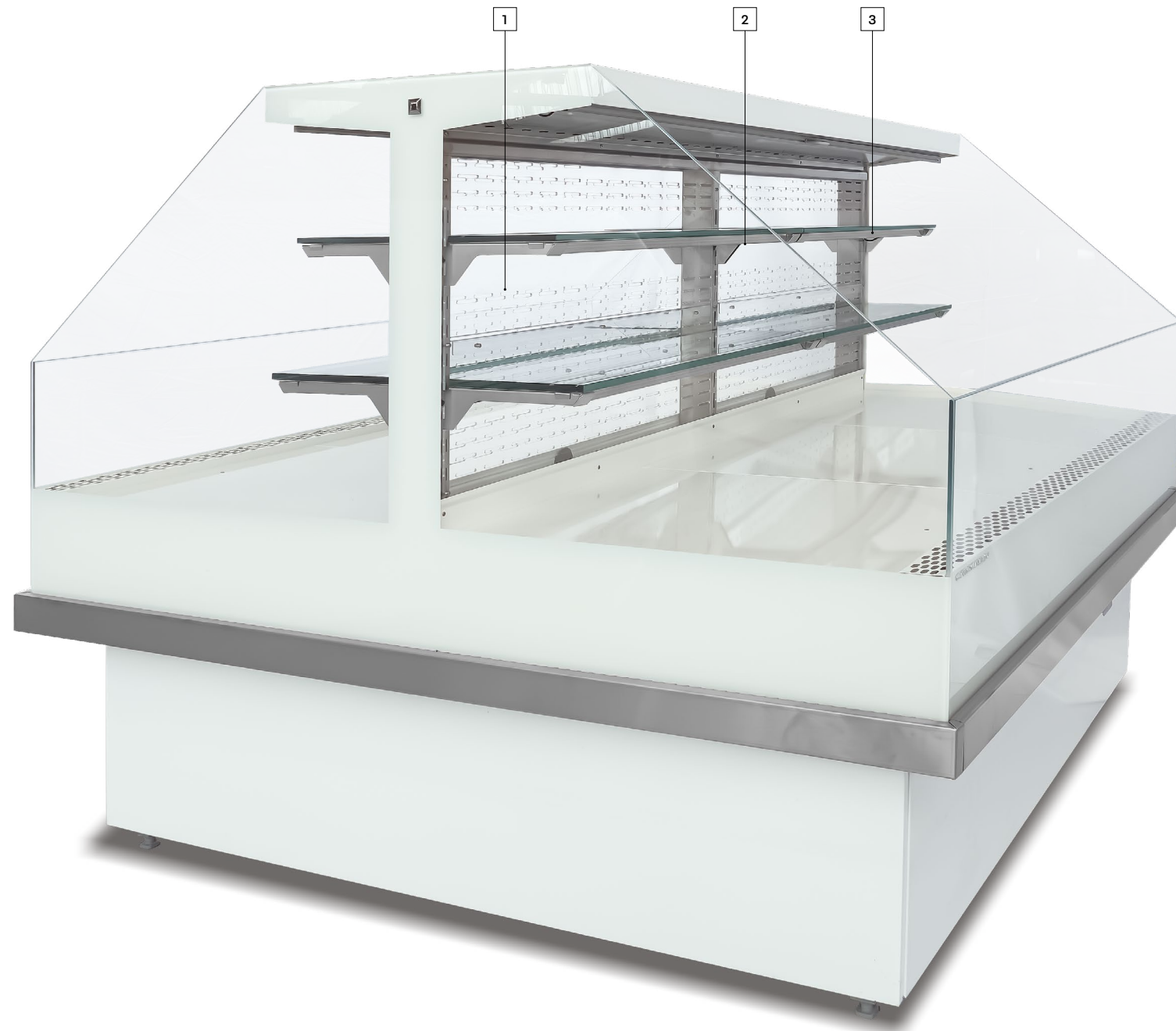

# ERIN E

Erin E is distinguished by its use of highly transparent materials, offering exceptional visibility from every angle.

Its 360° structure ensures complete accessibility for customers, facilitating interaction with the displayed products. Perfect for showcasing promotional and high-quality products, Erin E combines elegance and functionality, ensuring that each product is optimally highlighted.

**IT**  
Erin E si caratterizza per l'uso di materiali di massima trasparenza, offrendo una visibilità eccezionale da ogni angolazione. La sua struttura a 360° garantisce un'accessibilità totale ai clienti, facilitando l'interazione con i prodotti esposti. Perfetto per esporre prodotti promozionali e di alta qualità, Erin E combina eleganza e funzionalità, assicurando che ogni prodotto sia valorizzato al meglio.

**FR**  
Erin E se distingue par l'utilisation de matériaux de haute transparence, offrant une visibilité exceptionnelle sous tous les angles. Sa structure à 360° garantit une accessibilité totale pour les clients, facilitant l'interaction avec les produits exposés. Parfait pour mettre en valeur des produits promotionnels et de haute qualité, Erin E allie élégance et fonctionnalité, assurant que chaque produit soit mis en valeur de manière optimale.

**DE**  
Erin E zeichnet sich durch die Verwendung von hochtransparenten Materialien aus und bietet eine außergewöhnliche Sichtbarkeit aus jedem Winkel. Seine 360°-Struktur gewährleistet eine vollständige Zugänglichkeit für die Kunden und erleichtert die Interaktion mit den ausgestellten Produkten. Perfekt zur Präsentation von Werbe- und hochwertigen Produkten kombiniert Erin E Eleganz und Funktionalität und stellt sicher, dass jedes Produkt optimal zur Geltung kommt.

**1** Height-adjustable tempered glass shelves.  
**IT** Ripiani in vetro temperato regolabili in altezza.  
**FR** Étagères en verre trempé réglables en hauteur.  
**DE** Höhenverstellbare Regalböden aus gehärtetem Glas.

**2** Backrest in Plexiglass.  
**IT** Schienale in Plexiglas.  
**FR** Dossier en plexiglas.  
**DE** Siebdruckfarben.

**3** LED lighting 4000° K.  
**IT** Illuminazione LED 4000° K.  
**FR** Éclairage LED 4000° K.  
**DE** LED-Beleuchtung 4000° K.

**4** Bumper rail.  
**IT** Tubo batticarrello.  
**FR** Tube pare-chocs.  
**DE** Siebdruckfarben.

**5** Glued glass product stopper.  
**IT** Fermaprodotto in vetro incollato.  
**FR** Butée de produit en verre collé.  
**DE** Verklebter Glas-Produktstopper.

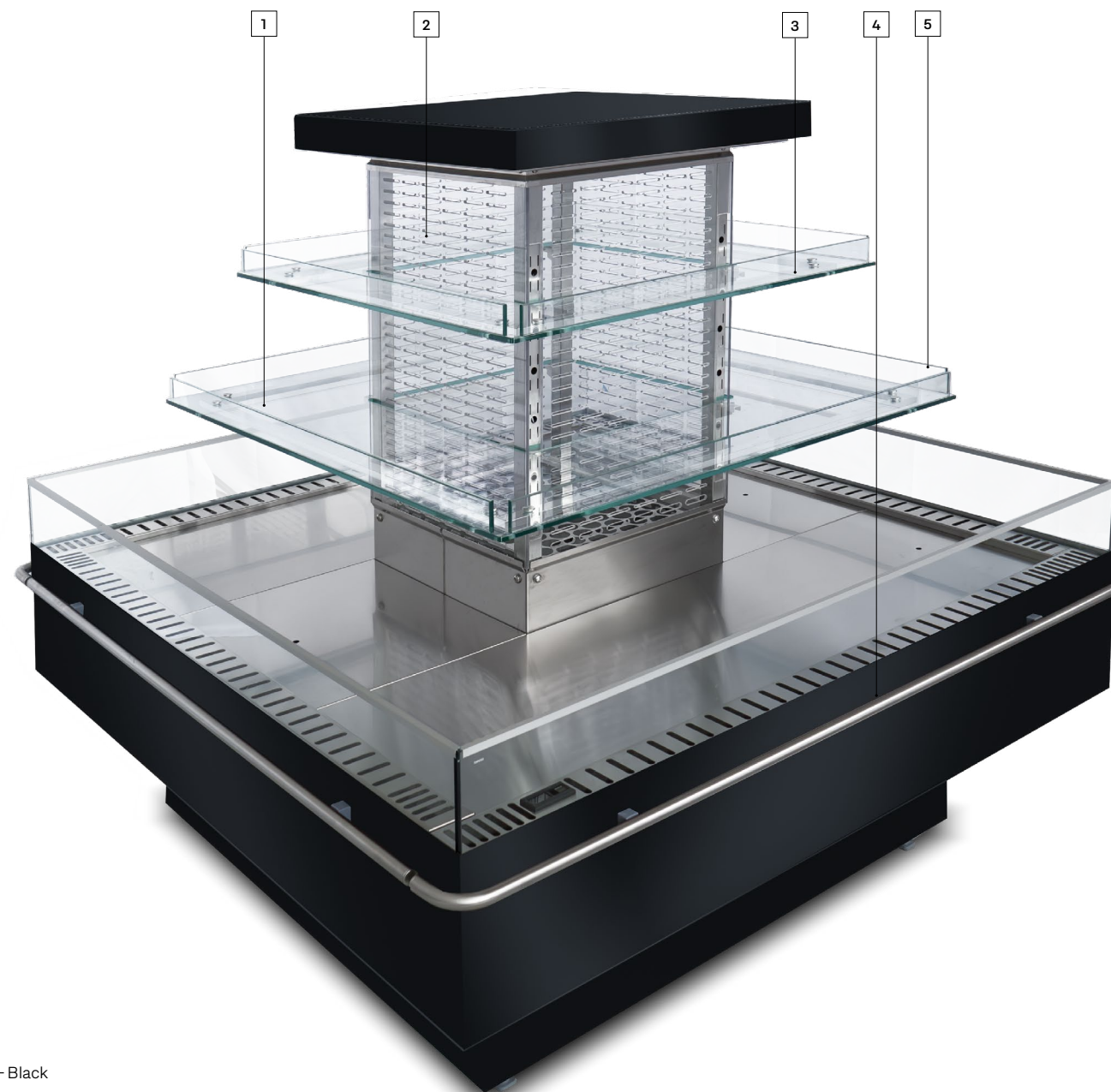

■ P73 - Black

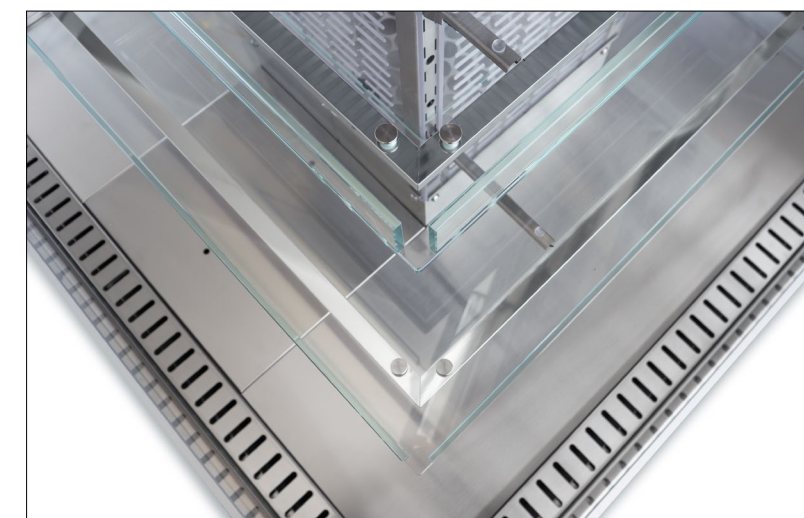
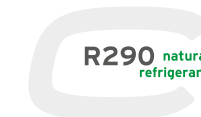

# EASY

The use of wire on tube condensers as standard ensures a 75% reduction in routine maintenance.

## IT

L'utilizzo di condensatori a filo di serie garantisce la riduzione del 75% degli interventi di manutenzione ordinaria.

## FR

L'utilisation de condensateurs à fil, de série, garantit la réduction de 75% des travaux de maintenance courante.

## DE

Der serienmäßige Einsatz von Drahtkondensatoren garantiert eine Reduzierung der routinemäßigen Wartung um 75 %.

1 Glass shelves.

IT Ripiani in vetro.

FR Étagères en verre.

DE Glasböden.

2 Transparent side panels and back panel for the unit.

IT Spalle e schiena del mobile trasparenti.

FR Montants et dos du meuble transparent.

DE Seitenteile und Rückwand des Möbels aus Plexiglas.

3 Stainless steel display surface.

IT Piano esposizione in acciaio inox.

FR Plan d'exposition en acier inoxydable.

DE Auslagefläche aus Edelstahl.

R290 natural refrigerant



<b>EM 100</b>	L (cm)*	125	187,5	250
<b>Consumo Annuo / Annual Energy Consumption</b>	<b>kWh/a</b>	<b>2417</b>	<b>3195</b>	<b>4592</b>
Classe climatica / Climate Class	ISO 23953-2	3 - M2		
Superficie espositiva / Display surface	m <sup>2</sup>	1,18	1,76	2,35
Carico uniformemente distribuito piano esposizione/ Uniformly distributed load display surface	kg/m <sup>2</sup>	105		
Gruppo frigorifero / Refrigeration unit	GAS	R290		
Controllo / Control	ELECTRONIC	Easy Touch Control		

<b>EM 120</b>	L (cm)*	125	187,5	250
<b>Consumo Annuo / Annual Energy Consumption</b>	<b>kWh/a</b>	<b>6130</b>	<b>8720</b>	<b>10.911</b>
Classe climatica / Climate Class	ISO 23953-2	3 - M2		
Superficie espositiva / Display surface	m <sup>2</sup>	1,73	2,59	3,45
Carico uniformemente distribuito piano esposizione/ Uniformly distributed load display surface	kg/m <sup>2</sup>	105		
Gruppo frigorifero / Refrigeration unit	GAS	R290		
Controllo / Control	ELECTRONIC	Easy Touch Control		

<b>EM 140</b>	L (cm)*	125	187,5	250
<b>Consumo Annuo / Annual Energy Consumption</b>	<b>kWh/a</b>	<b>6960</b>	<b>10.554</b>	<b>13.030</b>
Classe climatica / Climate Class	ISO 23953-2	3 - M2		
Superficie espositiva / Display surface	m <sup>2</sup>	2,23	3,34	4,45
Carico uniformemente distribuito piano esposizione/ Uniformly distributed load display surface	kg/m <sup>2</sup>	105		
Gruppo frigorifero / Refrigeration unit	GAS	R290		
Controllo / Control	ELECTRONIC	Easy Touch Control		

<b>EW 100</b>	L (cm)*	125	187,5	250
<b>Consumo Annuo / Annual Energy Consumption</b>	<b>kWh/a</b>	<b>3002</b>	<b>3772</b>	<b>5619</b>
Classe climatica / Climate Class	ISO 23953-2	3 - M2		
Superficie espositiva / Display surface	m <sup>2</sup>	1,61	2,42	3,23
Carico uniformemente distribuito piano esposizione/ Uniformly distributed load display surface	kg/m <sup>2</sup>	105		
Gruppo frigorifero / Refrigeration unit	GAS	R290		
Controllo / Control	ELECTRONIC	Easy Touch Control		

<b>EW 120</b>	L (cm)*	125	187,5	250
<b>Consumo Annuo / Annual Energy Consumption</b>	<b>kWh/a</b>	<b>6959</b>	<b>10.050</b>	<b>12.482</b>
Classe climatica / Climate Class	ISO 23953-2	3 - M2		
Superficie espositiva / Display surface	m <sup>2</sup>	2,13	3,19	4,25
Carico uniformemente distribuito piano esposizione/ Uniformly distributed load display surface	kg/m <sup>2</sup>	105		
Gruppo frigorifero / Refrigeration unit	GAS	R290		
Controllo / Control	ELECTRONIC	Easy Touch Control		

<b>EW 140</b>	L (cm)*	125	187,5	250
<b>Consumo Annuo / Annual Energy Consumption</b>	<b>kWh/a</b>	<b>8752</b>	<b>13.199</b>	<b>15.988</b>
Classe climatica / Climate Class	ISO 23953-2	3 - M2		
Superficie espositiva / Display surface	m <sup>2</sup>	2,63	3,94	5,25
Carico uniformemente distribuito piano esposizione/ Uniformly distributed load display surface	kg/m <sup>2</sup>	105		
Gruppo frigorifero / Refrigeration unit	GAS	R290		
Controllo / Control	ELECTRONIC	Easy Touch Control		

ERIN MINI

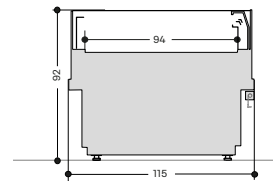

EM 100

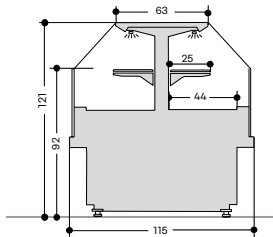

EM 120

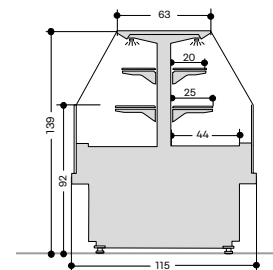

EM 140

ERIN LARGE

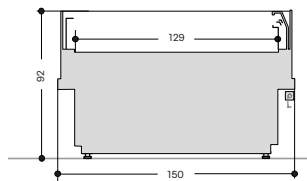

EW 100

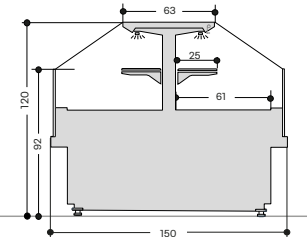

EW 120

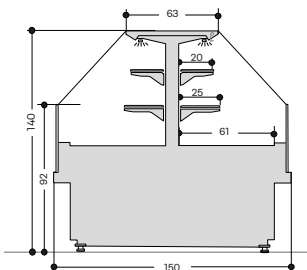

EW 140



\* Le informazioni relative alla classe energetica (secondo le normative Ecodesign 2019/2024 ed Energy Labelling 2019/2018) qui riportate sono riferite a modelli standard e precise configurazioni ed allestimenti del prodotto. La brochure si basa sulle informazioni disponibili al momento della sua pubblicazione. Ogni configurazione diversa da quella ivi rappresentata potrebbe comportare un cambiamento sensibile delle informazioni relative alla classe energetica. Per maggiori informazioni vi invitiamo a consultare il Registro Europeo dei Prodotti per l'Etichettatura Energetica EPREL oppure rivolgerci al nostro servizio criocare@criocabin.com.

\* **EN** The energy class information (according to the Ecodesign 2019/2024 and the Energy Labelling 2019/2018 standards) given here refers to standard models and precise product configurations and fittings. The brochure is based on the information available at the time of its publication. Any configuration other than that depicted therein may result in a significant change in the energy class information. For further information, please consult the European Product Registry for Energy Labelling (EPREL) or contact our service criocare@criocabin.com.

<b>XL 100</b>	L (cm)*	125	187,5	250	375
<b>Consumo Annuo / Annual Energy Consumption</b>	<b>kWh/a</b>	<b>3574</b>	<b>4252</b>	<b>5960</b>	-
Classe climatica / Climate Class	ISO 23953-2	3 - M2			
Superficie espositiva / Display surface	m <sup>2</sup>	1,90	2,85	3,80	5,70
Carico uniformemente distribuito piano esposizione/ Uniformly distributed load display surface	kg/m <sup>2</sup>	105			
Gruppo frigorifero / Refrigeration unit	GAS	R290			
Controllo / Control	ELECTRONIC	Easy Touch Control			

<b>XL 120</b>	L (cm)*	125	187,5	250	375
<b>Consumo Annuo / Annual Energy Consumption</b>	<b>kWh/a</b>	<b>8109</b>	<b>10.636</b>	-	-
Classe climatica / Climate Class	ISO 23953-2	3 - M2			
Superficie espositiva / Display surface	m <sup>2</sup>	2,53	3,79	5,05	7,58
Carico uniformemente distribuito piano esposizione/ Uniformly distributed load display surface	kg/m <sup>2</sup>	105			
Gruppo frigorifero / Refrigeration unit	GAS	R290			
Controllo / Control	ELECTRONIC	Easy Touch Control			

<b>XL 140</b>	L (cm)*	125	187,5	250	375
<b>Consumo Annuo / Annual Energy Consumption</b>	<b>kWh/a</b>	<b>10.743</b>	<b>13.123</b>	-	-
Classe climatica / Climate Class	ISO 23953-2	3 - M2			
Superficie espositiva / Display surface	m <sup>2</sup>	3,03	4,54	6,05	9,08
Carico uniformemente distribuito piano esposizione/ Uniformly distributed load display surface	kg/m <sup>2</sup>	105			
Gruppo frigorifero / Refrigeration unit	GAS	R290			
Controllo / Control	ELECTRONIC	Easy Touch Control			

**Condensatori con sistema autopulente di serie (riduce dell'80% gli interventi di manutenzione ordinaria)**

**Condensers fitted with a standard self-cleaning system (reducing regular maintenance operations by 80%)**



ERIN EXTRA LARGE

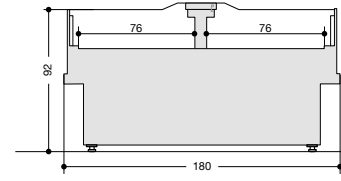

XL 100

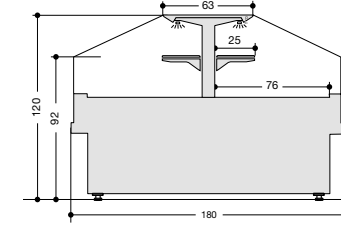

XL 120

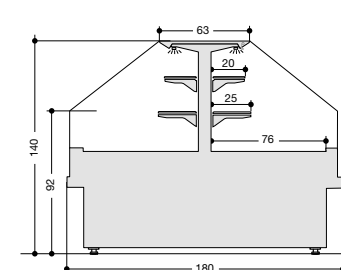

XL 140

L (cm)\*= Lunghezza senza spalle. Spessore 1 spalla: 3 cm.  
L (cm)\*= Length without endwalls. Thickness 1 endwall: 3 cm.

Le caratteristiche tecniche potranno subire modifiche senza preavviso.  
**EN** Technical details could be changed without notice.  
**FR** Les caractéristiques techniques pourraient subir des modifications sans préavis.  
**DE** Änderungen vorbehalten.

<b>XL 100 TESTATA</b>	L (cm)*	167,5
<b>Consumo Annuo / Annual Energy Consumption</b>	<b>kWh/a</b>	<b>2756</b>
Classe climatica / Climate Class	ISO 23953-2	3 - M2
Superficie espositiva / Display surface	m <sup>2</sup>	1,17
Carico uniformemente distribuito piano esposizione/ Uniformly distributed load display surface	kg/m <sup>2</sup>	105
Gruppo frigorifero / Refrigeration unit	GAS	R290
Controllo / Control	ELECTRONIC	Easy Touch Control

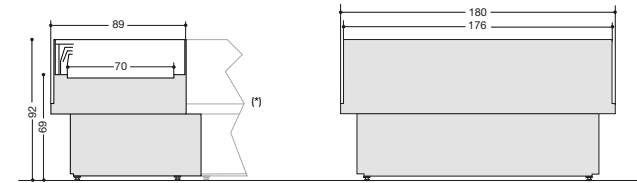

<b>XL 120 TESTATA</b>	L (cm)*	167,5
<b>Consumo Annuo / Annual Energy Consumption</b>	<b>kWh/a</b>	<b>5058</b>
Classe climatica / Climate Class	ISO 23953-2	3 - M2
Superficie espositiva / Display surface	m <sup>2</sup>	1,49
Carico uniformemente distribuito piano esposizione/ Uniformly distributed load display surface	kg/m <sup>2</sup>	105
Gruppo frigorifero / Refrigeration unit	GAS	R290
Controllo / Control	ELECTRONIC	Easy Touch Control

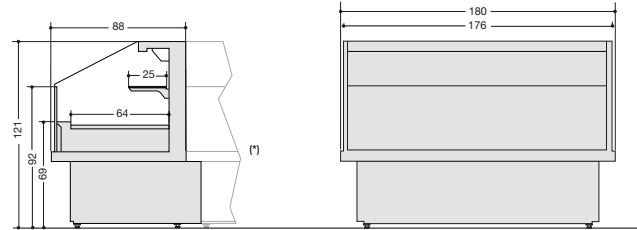

<b>XL 140 TESTATA</b>	L (cm)*	167,5
<b>Consumo Annuo / Annual Energy Consumption</b>	<b>kWh/a</b>	<b>5746</b>
Classe climatica / Climate Class	ISO 23953-2	3 - M2
Superficie espositiva / Display surface	m <sup>2</sup>	1,81
Carico uniformemente distribuito piano esposizione/ Uniformly distributed load display surface	kg/m <sup>2</sup>	105
Gruppo frigorifero / Refrigeration unit	GAS	R290
Controllo / Control	ELECTRONIC	Easy Touch Control

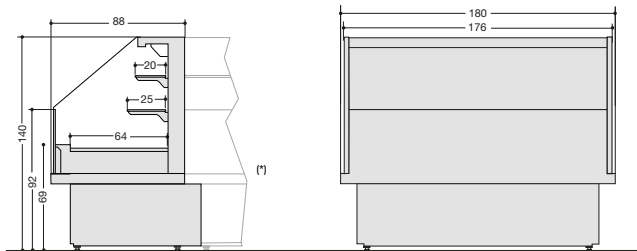

<b>ERINE</b>	L (cm)*	146
<b>Consumo Annuo / Annual Energy Consumption (remote)</b>	<b>kWh/a</b>	<b>1134</b>
Classe climatica / Climate Class	ISO 23953-2	3 - H1
Superficie espositiva / Display surface	m <sup>2</sup>	2,56
Carico uniformemente distribuito piano esposizione/ Uniformly distributed load display surface	kg/m <sup>2</sup>	105
Controllo / Control	ELECTRONIC	Easy Touch Control

L (cm)\*= Lunghezza senza spalle.  
L (cm)\*= Length without endwalls.

Le caratteristiche tecniche potranno subire modifiche senza preavviso.  
**EN** Technical details could be changed without notice.  
**FR** Les caractéristiques techniques pourraient subir des modifications sans préavis.  
**DE** Änderungen vorbehalten.

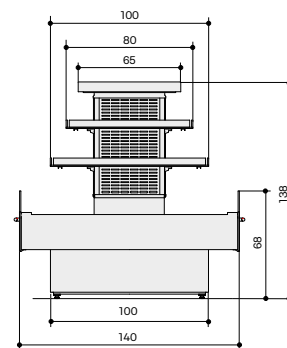

<b>EA 100</b>	L (cm)*	125
<b>Consumo Annuo / Annual Energy Consumption</b>	<b>kWh/a</b>	<b>3092</b>
Classe climatica / Climate Class	ISO 23953-2	3 - M1
Superficie espositiva / Display surface	m <sup>2</sup>	1,18
Carico uniformemente distribuito piano esposizione/ Uniformly distributed load display surface	kg/m <sup>2</sup>	105
Gruppo frigorifero / Refrigeration unit	GAS	R290
Controllo / Control	ELECTRONIC	Easy Touch Control

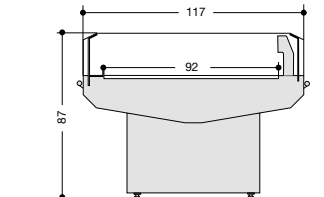

EA 100

<b>EA 120</b>	L (cm)*	125
<b>Consumo Annuo / Annual Energy Consumption</b>	<b>kWh/a</b>	<b>5876</b>
Classe climatica / Climate Class	ISO 23953-2	3 - M1
Superficie espositiva / Display surface	m <sup>2</sup>	1,15
Carico uniformemente distribuito piano esposizione/ Uniformly distributed load display surface	kg/m <sup>2</sup>	105
Gruppo frigorifero / Refrigeration unit	GAS	R290
Controllo / Control	ELECTRONIC	Easy Touch Control

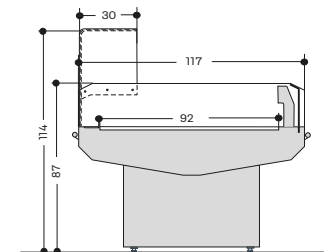

EA 120

<b>EA 130</b>	L (cm)*	125
<b>Consumo Annuo / Annual Energy Consumption</b>	<b>kWh/a</b>	<b>6102</b>
Classe climatica / Climate Class	ISO 23953-2	3 - M1
Superficie espositiva / Display surface	m <sup>2</sup>	2,05
Carico uniformemente distribuito piano esposizione/ Uniformly distributed load display surface	kg/m <sup>2</sup>	105
Gruppo frigorifero / Refrigeration unit	GAS	R290
Controllo / Control	ELECTRONIC	Easy Touch Control

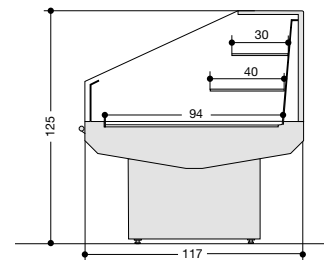

EA 130

**Condensatori con sistema autopulente di serie**  
**(riduce dell'80% gli interventi di manutenzione ordinaria)**  
**Condensers fitted with a standard self-cleaning system**  
**(reducing regular maintenance operations by 80%)**



L (cm)\*= Lunghezza senza spalle. Spessore 1 spalla: 2,6 cm.  
L (cm)\*= Length without endwalls. Thickness 1 endwall: 2,6 cm.

Le caratteristiche tecniche potranno subire modifiche senza preavviso.  
**EN** Technical details could be changed without notice.  
**FR** Les caractéristiques techniques pourraient subir des modifications sans préavis.  
**DE** Änderungen vorbehalten.





**Erin XL** is ideal for adapting to the style of your store, offering maximum capacity in a small space.

**Erin XL** è ideale per adattarsi allo stile del tuo punto vendita, offrendo massima capienza in poco spazio.

**Erin XL** est idéal pour s'adapter au style de votre point de vente, offrant une capacité maximale dans un espace réduit.

**Erin XL** ist ideal, um sich dem Stil Ihres Verkaufsraums anzupassen und bietet maximale Kapazität auf kleinem Raum.



**Erin E** gives your products maximum visibility and makes your store layout flexible.

**Erin E** dona massima visibilità ai tuoi prodotti e rende flessibile il layout del tuo negozio.

**Erin E** donne une visibilité maximale à vos produits et rend la disposition de votre magasin flexible.

**Erin E** verleiht Ihren Produkten maximale Sichtbarkeit und macht das Layout Ihres Geschäfts flexibel.



See It, Want It, Buy It

**Easy**, with its modern and clean design, in either *total white* or *total black*, enhances the environment in which it is placed.

**Easy**, dal design moderno e pulito, con i suoi colori *total white* o *total black*, fa risaltare l'ambiente nel quale è inserito.

**Easy**, avec son design moderne et épuré, en *total white* ou *total black*, met en valeur l'environnement dans lequel il est intégré.

**Easy**, mit seinem modernen und sauberen Design, in *total white* oder *total black*, hebt die Umgebung hervor, in der es platziert ist.

# ERIN & EASY

## DESIGNED TO IMPRESS

**CRIOCABIN**  
TASTE PRESENTATION

**CRIOCABIN SpA**

35037 Praglia di Teolo - Padova (Italy)  
Z.I. Selve - Via S. Benedetto, 40/A

Tel. +39 049 9909100  
[www.criocabin.com](http://www.criocabin.com)

Fotografie / Creative Studio

Progettografico / Criocabin